

MODEL LP

LOCKING TYPE

Suitable up to 90° lateral and transverse WLL, with universal carrying ring. Each clamp is tested for 2 x WLL, provided with a serial number, and is delivered with a certificate and CE-marking.

Safety factor 3:1. Suitable up to a sheet surface hardness of 363 HV 10 (341 HB / 37 RC). Made of high strength steel. Each clamp is given a RFID transponder as standard, for simplified inspection and documentation. LP-vertical clamps are equipped with a lever for locking the open and closed position. Area of application temperature: -20 °C to 100 °C (ambient and load temperature). The LP-clamps are compact and easy to operate. The construction design of the LP-clamps allows simple repair and maintenance.

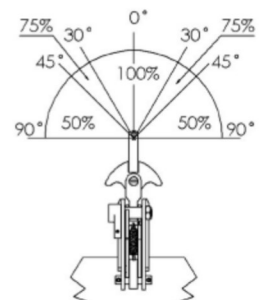
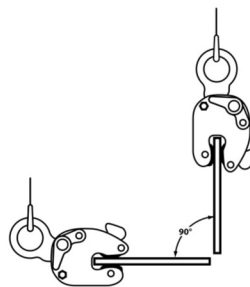
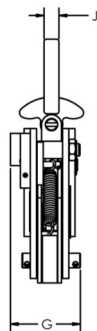
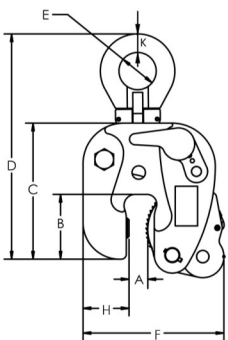

Type	Mat. no.	W.L.L.	Kg	T (mm)	A (mm)	B (mm)	C (mm)	D (mm)	E (mm)	F (mm)	G (mm)	H (mm)	J (mm)	K (mm)
LP 0,5 t	8505248	0,5 t	2,17	232	0-16	51	124	223	29	114	62	35	13	12.7
LP 1 t	8505249	1 t	2,45	232	0-19	51	124	223	29	114	62	35	13	12.7
LP 2 t	8505250	2 t	8,86	336	0-25	84	175	318	60	184	92	60	19	23.8
LP 3 t	8505251	3 t	16,15	427	0-25	84	254	413	92	216	97	70	19	27.0